



**W. Schmid AG**

LED-Technology  
the visible difference

## Surface mounted LED indicator ABL45C



ABL45C, 24 VDC

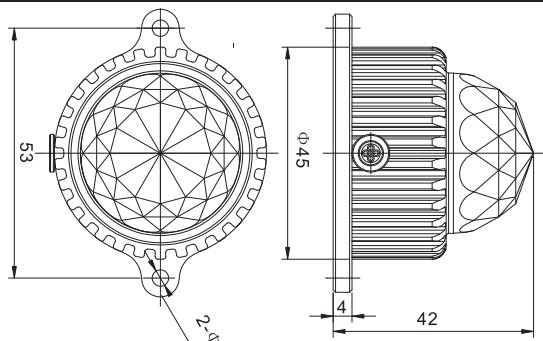

2 mounting holes  $\varnothing=3,5\text{mm}$ ,  
distance: 53mm

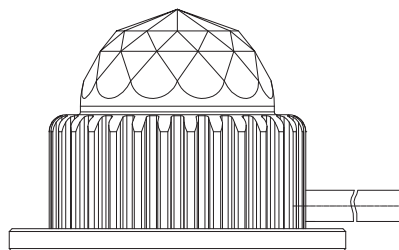

lateral cable outlet

### Specifications:

Description:	Surface mounted LED indicator ABL45C, 45mm, convex
Dimensions:	$\varnothing=45\text{mm}$ , $H=42\text{mm}$
Supply voltage:	24 VDC
Power consumption:	1.44W
Viewing angle:	120°
Degree of protection:	IP 65
Class of protection:	III
Operating temperature:	-25 up to +50°C
Material:	Black anodized aluminium, transparent diffuser lens
Weight:	0.09kg
Connection:	Cable, length: 0.6-0.7m
Available ill. colours:	white, warm white, red, yellow, green, blue, orange, RGB
Applications:	Pilot light, access control, machine illumination, wall lamp, floor lamp, alarm indicator etc.