



W. Schmid AG

LED-Technology
the visible difference

Surface mounted LED spot ABS42



ABS42, 3.7 VDC

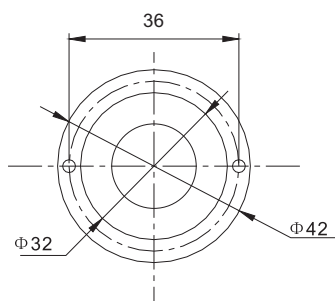

2 mounting holes $\text{Ø}=3,5\text{mm}$,
distance: 36mm

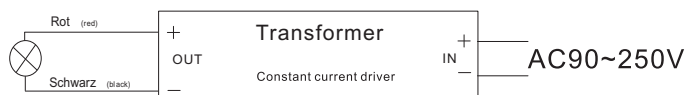

2 lateral cable outlets,
connection of power pack as shown

Specifications:

Description:	Surface mounted flat LED spot ABS42, 42mm
Dimensions:	$\text{Ø}=42\text{mm}$, $H=19\text{mm}$
Supply voltage:	3.7 VDC
Power consumption:	1.0W
Viewing angle:	15°
Degree of protection:	IP 65
Class of protection:	III
Operating temperature:	-25 up to $+50^\circ\text{C}$
Material:	Colourless anodized aluminium, transparent lens
Weight:	0.04kg
Connection:	Cable, length: 0.15-0.25m
Available ill. colours:	white, warm white, red, yellow, green, blue, orange
Applications:	Pilot light, access control, machine indicator, wall lamp, floor lamp, alarm indicator etc.